

Riviera • Deck 4

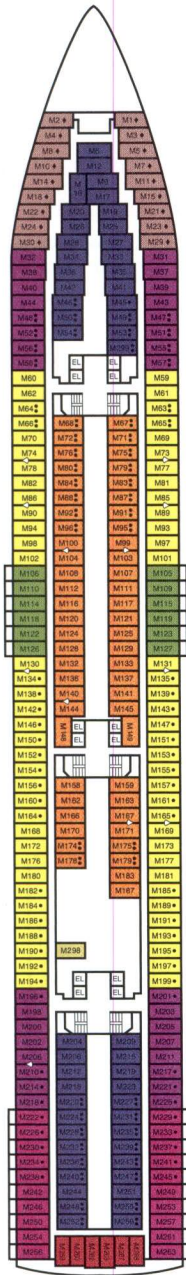

Main • Deck 5

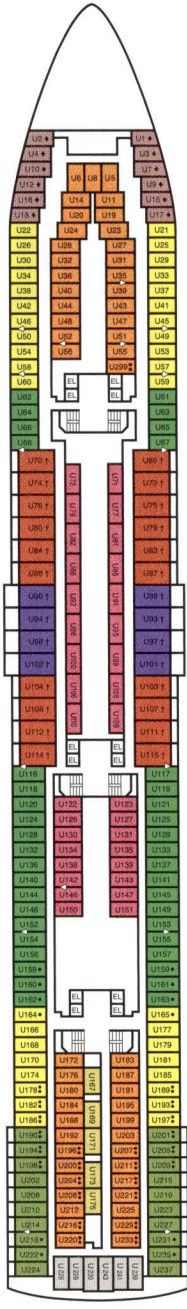

Upper • Deck 6

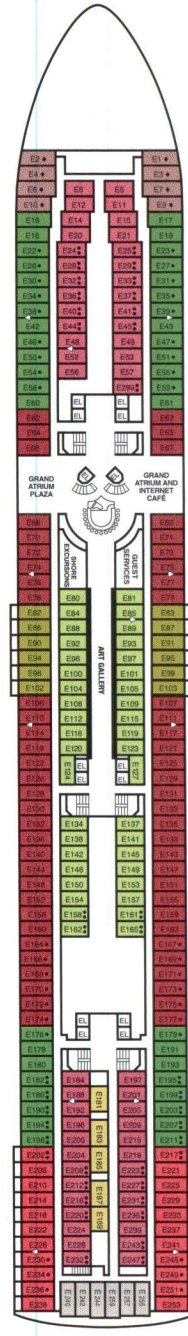

Empress • Deck 7

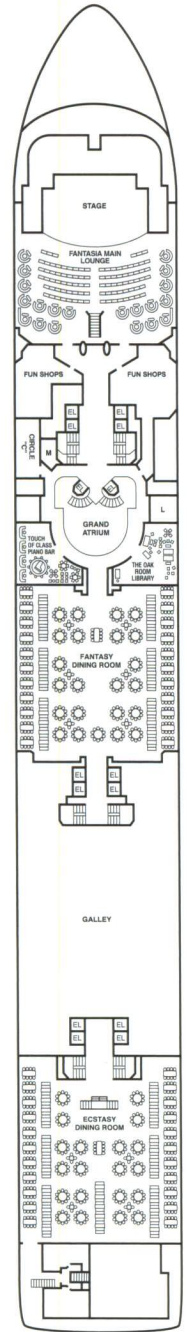

Atlantic • Deck 8

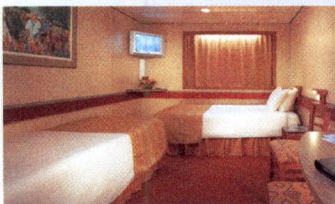

Categories:

- Interior: 4A
- 4B
- 4C
- 4D
- 4E
- 4F

Interior Upper/Lower: 1A (not pictured): Feature upper and lower beds



Categories:

- Ocean View: 6A
- 6B
- 6C
- 6D
- 6E

Porthole Ocean View: 5A (not pictured): Feature two portholes instead of a



Categories:

- Balcony: 8A
- 8B
- 8C
- 8D

Aft-View Extended Balcony: 8E

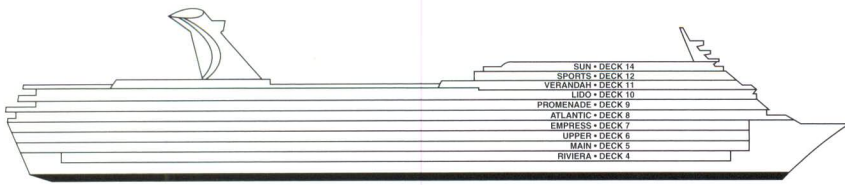

Gross Tonnage: 70,367 Length: 855 Feet Beam: 103 Feet Cruising Speed: 21 Knots
 Guest Capacity: 2,052 (Double Occupancy) Total Staff: 920 Registry: The Bahamas

Accommodation Symbol Legend

- 2 Uppers
- 1 Upper
- ★ Twin Bed/King and Single Convertible Sofa
- † Twin Bed/King and Double Convertible Sofa
- ◆ Stateroom with 2 Porthole Windows
- ◊ Connecting Staterooms (Ideal for families and groups of friends)

11 Suites with obstructed views: V23, V25, V27, V34, V38 & V42.

5 Extended balcony 50% larger than Standard balcony.

Staterooms are available that are modified for wheelchair users. Please contact Carnival Reservations Department, Guest Access Services, at 1-800-438-6744, ext. 70025, for details.

Even-numbered Interior staterooms exit port side (left); odd-numbered Interior staterooms exit starboard (right).

Deck Plans

For a closer look at our ship deck plans or to take a 360° tour visit carnival.com/funships.

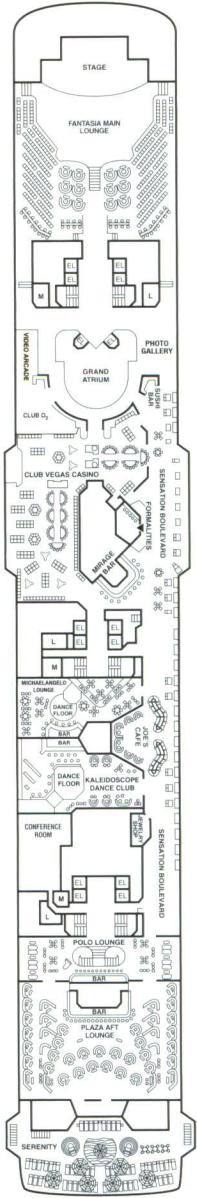

Promenade • Deck 9

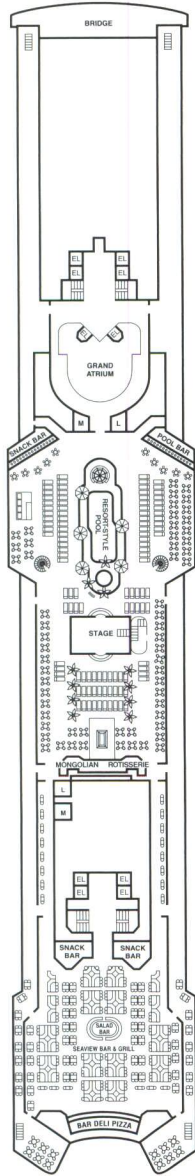

Lido • Deck 10

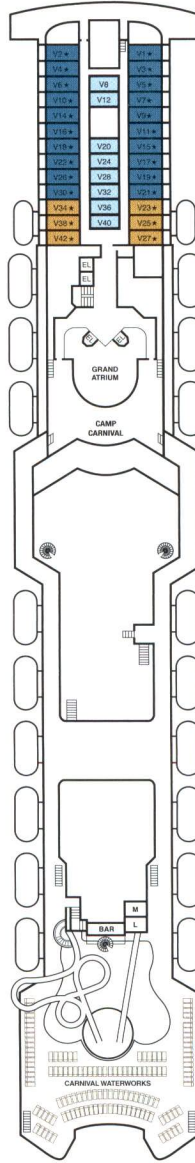

Verandah • Deck 11



Forward Sports • Deck 12

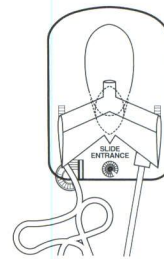

Aft Sports • Deck 12

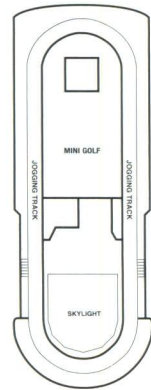

Sun • Deck 14



Categories:

Suite: **11** **11** (obstructed views)



Categories:

Penthouse Suite: **12**

Extended Balcony Penthouse Suite: **55⁹**

BURNS WORLD TRAVEL LTD - STATESBORO, GA USA
 WWW.BURNSWORLDTRAVEL.COM